

# PRODUCT SUBMITTAL



## Core Clear Ladder Design

### Description:

16" O.C. ladder design positions cross rods on web of block to allow core clearance. This simplifies rebar installation; centering utilizes strength of grout. Allows unrestricted flow of grout or loose fill insulation into CMU cells. Minimizes re-setting of joint reinforcement around rebar. Improves resistance to shrinkage cracking. Provides stronger bond with cross rods in web of block. Less time devoted to rebar installation, grout pouring.

Ladder design is a prefabricated reinforcement for embedment in the horizontal mortar joints of masonry. It is manufactured in 10' 8" lengths from wire conforming to ASTM A 82 for cold drawn steel wire. It consists of two or more parallel and deformed longitudinal wires welded to perpendicular cross wire spaced 16" O.C. Out-to-out spacing is approximately two inches less than the nominal thickness of the wall.

2 Wire System (Series 200)

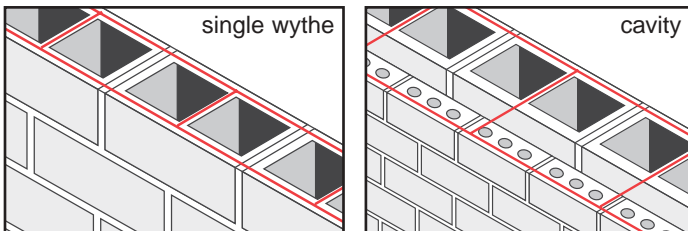

3 Wire System (Series 200)

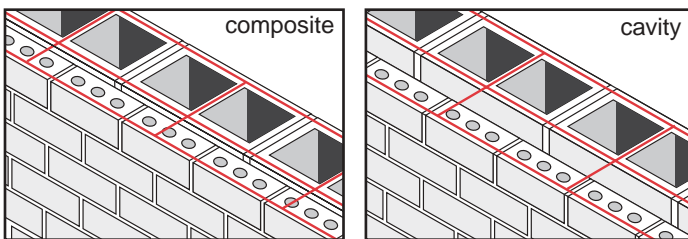

4 Wire System (Series 200)

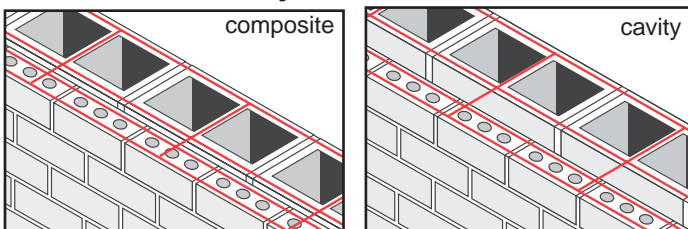

## Specifications:

All products conform to:

ASTM A641 - (Mill galvanized wire)	ASTM A951-96 - (Masonry wall reinforcing)
ASTM A153 Class B2 - (Hot dipped after fabrication)	ASTM 580 Type 304 - (Stainless steel)
ASTM A 82 - (Cold drawn steel wire)	ACI/ASCE 530 - (Building code requirements for masonry structures)

Wire Gauges:

	Side Rods	Cross Rods
Standard	9 Gauge (.148 in)	9 Gauge
Medium	8 Gauge (.162 in)	9 Gauge
Heavy Duty	3/16" (.187 in)	9 Gauge
Extra Heavy Duty	3/16" (.187 in)	3/16"

Finishes:

Plain	Uncoated
Mill Galvanized	Zinc Coated (0.10 oz per sq ft)
Hot Dipped Galvanized After Fabrication	Zinc Coated ASTM A 153 Class B2 (1.50 oz per sq ft)
Stainless Steel	ASTM 580 Type 304

Class I ASTM A641 (0.4 oz/ft<sup>2</sup>) and Class III (0.8 oz/ft<sup>2</sup>) are no longer recommended by ASI 530 for interior walls. Epoxy coating is not recommended as a protected coating for joint reinforcement, anchors and ties. Manufacturer recommends Stainless Steel Type 304 for maximum corrosion protection.

## Prefabricated Corners and Tees:

Ladder Tee

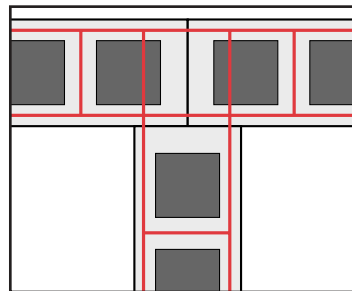

Ladder Corner

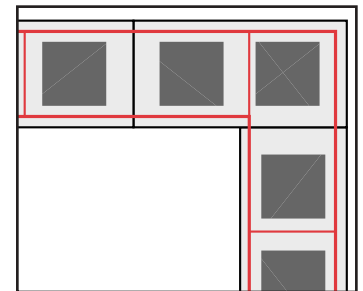

Approvals:

Comments:

**Corporate Office**  
 400 Roundtree Rd  
 PO Box 240988  
 Charlotte, NC 28224  
 704 525.5554  
 800 849.6722  
 Fax 704 525.3761

**Memphis Plant**  
 2365 Harbor Ave.  
 PO Box 13124  
 Memphis, TN 38113  
 901 775.9444  
 800 441.8359  
 Fax 901 775.9449